

## Specifications

<https://bnk-global.com.au/>



# PRATO +

## FREESTANDING ACYLIC BATHTUB 1700MM

**PRODUCT CODE: BTA-1700MW**

### FEATURES:

- Material: Mitsubishi Premium sanitary-grade acrylic
- Matte acrylic exterior & interior
- Color: Matte White
- Capacity: 379 Litres
- Weight: 42kg (Net) / 53kg (Gross)
- Style: Freestanding
- Built-in stainless steel support frame
- Adjustable Steel Legs
- No overflow
- Waste not included with bath
- UV-stabilised, but not recommended for outdoor use

### WARRANTIES:

10 Years/ 1-year Labour

### CLEANING AND CARE:

- Use warm water, mild soap, and a soft cloth. Avoid abrasive cleaners.
- Do not use bleach, ammonia, or acetone.
- Use a baking soda paste and soft cloth for light stains.
- Avoid placing sharp or heavy objects in the tub.
- Not recommended for outdoor installation.

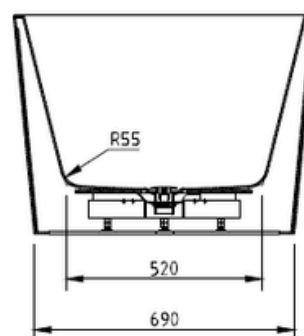
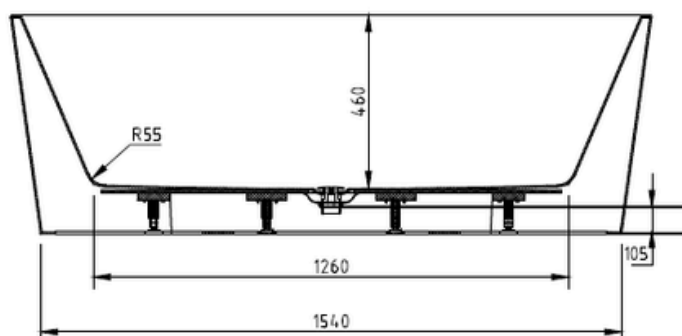
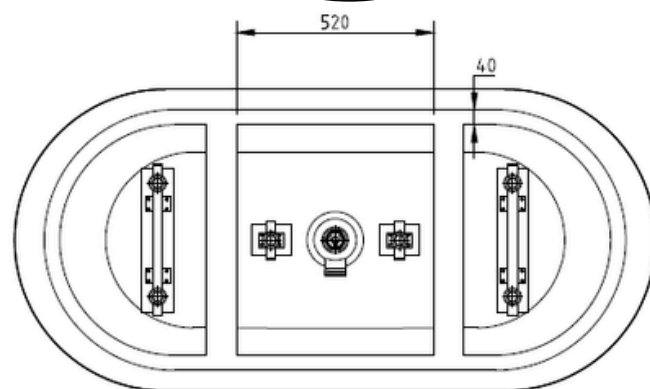
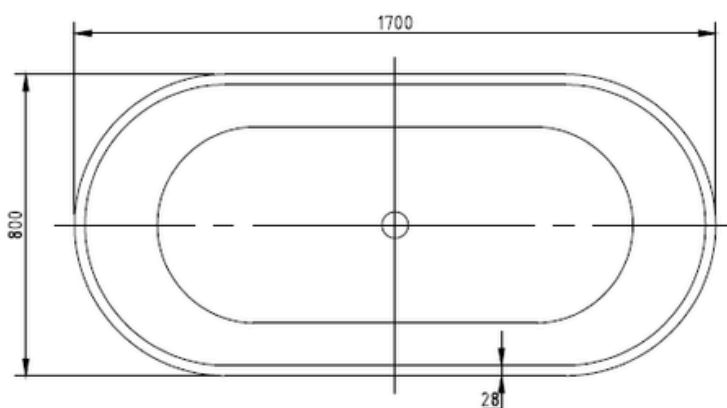

Disclaimer: Products in this specification manual must by regulation be installed by licensed and registered tradespeople. The manufacturer/distributor reserves the right to vary specifications or delete models from their range without prior notification. Updated: 23/04/2025